

Item description/product images

## Drawings

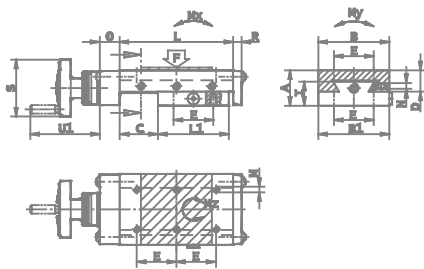

## Overview of items

|   |   |
|---|---|
| BEST (Order No.)                                      | 21033-150210  |
| A (total height / mm)                                 | 50  |
| B (Width / mm)  | 150   |
| B1 (Width / mm)                                       | 149   |
| C (Stroke / mm)                                       | 50  |
| D (height of carriage / mm)                           | 29.5  |
| E (Borehole distance / mm)                            | 130   |
| TI (number of fastening holes E/M internal part / mm) | 4   |
| TA (number of fastening holes E/M external part / mm) | 4   |
| I (Height / mm)                                       | 35.5  |
| L (Length / mm)                                       | 210   |
| L1 (Length / mm)                                      | 150   |
| M (threaded hole / mm)                                | M 8   |
| N (lateral threaded hole / mm)                        | M 8   |
| O (Length / mm)                                       | 28  |
| R (Length / mm)                                       | 8   |
| S (Length / mm)                                       | 80  |
| U1 (Length / mm)                                      | 100   |
| F (load-bearing capacity / N)                         | 917   |
| FIL (Spindle)   | Tr 16 x 2   |
| MX ( / Nm)  | 31  |
| MY ( / Nm)  | 128   |
| MZ ( / Nm)  | 33  |
| GEW (Approx. weight / kg)                             | 10.3480   |
| BS (Description)                                      | Infotext  |
| ROHS (RoHS)   | Yes   |
| ZTN (Customs tariff number)                           | 84798994  |
| EAN (EAN-Nr. norelem)                                 | 4059495219783   |
| EOL (End of life)                                     | 31.12.2099  |
| STD LZ (Standardlieferzeit)                           | 98% availability of products. Almost all articles from the range are available from stock and are dispatched immediately from the central warehouse after receipt of order. Items not in stock are usually procured promptly. Availability is displayed live in the shop. |
| WARTUNG (Betriebs- und Wartungshinweise)              | Maintenance interval see operating instructions   |