

## Datasheet - AZM190-02/01RK-24VDC

Solenoid interlock / AZM190



- Thermoplastic enclosure
- Long life
- Interlock with protection against incorrect locking.
- 89 mm x 178 mm x 41 mm
- Actuating head can be repositioned by 4 x 90°
- 2 cable entries M 20 x 1.5
- Wiring compartment
- Slim design, particularly suitable for fitting on hinged doors, aluminium profiles and fencing
- Sealing mechanism to prevent the ingress of dirt
- Cut clamp termination
- Manual release

(Minor differences between the printed image and the original product may exist!)

### Ordering details

Product type description	AZM190-02/01RK-24VDC
Article number	101178901
EAN code	4030661451633
Replaced article number 101178002	
eCl@ss	27-27-26-03

### Approval

Approval

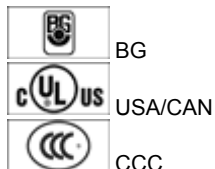

### Classification

Standards	EN ISO 13849-1
B <sub>10d</sub> Opener (NC)	2.000.000
B <sub>10d</sub> Normally open contact (NO)	1.000.000
Mission time	20 Years
notice	$MTTF_d = \frac{B_{10d}}{0,1 \times n_{op}}$ $n_{op} = \frac{d_{op} \times h_{op} \times 3600 \text{ s/h}}{t_{cycle}}$

Global Properties

Product name	AZM190
Standards	EN 60947-5-1, BG-GS-ET-19
Compliance with the Directives (Y/N) 	Yes
Number of actuating directions	4 piece
Active principle	electromechanical
Duty cycle	Magnet 100 %
Materials	
- Material of the housings	Plastic, glass-fibre reinforced thermoplastic
- Material of the contacts	Silver
Housing coating	None
Weight	480 g

Mechanical data

Connection type	Screw connection
Cable section	
- Min. Cable section	1 x 0,5 mm²
- Max. Cable section	1 x 1.5 mm²
Mechanical life	2.000.000 operations
notice	All indications about the cable section are including the conductor ferrules.
Emergency unlocking device (Y/N)	No
- front	
Manual release (Y/N)	Yes
Emergency release (Y/N)	No
Latching force	20 N
Positive break force	20 N
positive break travel	2 x 3.5 mm
Clamping force F	1950 N

Ambient conditions

Ambient temperature	
- Min. environmental temperature	0°C
- Max. environmental temperature	+50 °C
Protection class	IP67 to IEC/EN 60529

Electrical data

Design of control element	Normally open contact (NO), Opener (NC)
Switching principle	Creep circuit element
Number of auxiliary contacts	0 piece
Number of safety contacts	3 piece
Power to unlock	Yes
Power to lock	No
Rated control voltage U <sub>s</sub>	24 VDC
Power consumption	max. 8.5 W
Rated impulse withstand voltage U <sub>imp</sub>	4 kV
Rated insulation voltage U <sub>i</sub>	250 V
Thermal test current I <sub>the</sub>	4 A
Utilisation category	AC-15: 230 V / 4 A, DC-13: 24 V / 4 A

Max. fuse rating

4 A gG D-fuse DIN EN 60269-1

ATEX

Explosion protection categories for gases	None
Explosion protected category for dusts	None

Miscellaneous data

Applications	 hinged safety guard
--------------	-------------------------------------------------------------------------------------------------------

Dimensions



Dimensions of the sensor	
- Width of sensor	89 mm
- Height of sensor	178 mm
- Length of sensor	41 mm

notice

- Manual release
- For manual release using triangular key M3 (included in delivery)
  - For maintenance, installation, etc.

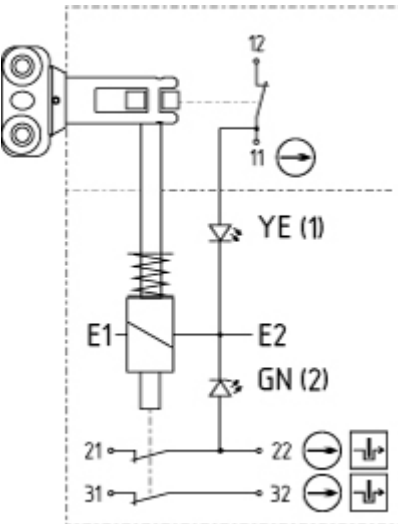
Diagram

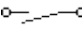
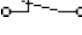

- Note Diagram
-  positive break NC contact
  -  active
  -  no active
  -  Normally-open contact
  -  Normally-closed contact

Ordering code

AZM190-(1)RK(2)(3)-(4)-(5)

(1)

<b>02/01</b>	Magnet: 2 Opener (NC); Actuator: 1 Opener (NC)
<b>02/02</b>	Magnet: 2 Opener (NC); Actuator 2 Opener (NC)
<b>02/10</b>	Magnet: 2 Opener (NC); Actuator: 1 Normally open contact (NO)
<b>02/11</b>	Magnet: 2 Opener (NC); Actuator: 1 Opener (NC) / 1 Normally open contact (NO)
<b>11/01</b>	Magnet: 1 Opener (NC) / 1 Normally open contact (NO); Actuator: 1 Opener (NC)
<b>11/02</b>	Magnet: 1 Opener (NC) / 1 Normally open contact (NO); Actuator: 2 Opener (NC)
<b>11/10</b>	Magnet: 1 Opener (NC) / 1 Normally open contact (NO); Actuator: 1 Normally open contact (NO)
<b>11/11</b>	Magnet: 1 Opener (NC) / 1 Normally open contact (NO); Actuator: 1 Opener (NC) / 1 Normally open contact (NO)
<b>(2)</b>	
<i>without</i>	Power to unlock
<b>A</b>	Power to lock
<b>(3)</b>	
<i>without</i>	With Manual release cover-side
<b>E0</b>	Without Manual release
<b>E1</b>	With Manual release lateral (right)
<b>N</b>	Emergency release
<b>T</b>	Emergency unlocking device
<b>(4)</b>	
<i>without</i>	Without LED switching conditions display
<b>G</b>	With LED switching conditions display (Only for 24 VAC/DC; not combinable in combination with -E1 und -T)
<b>(5)</b>	
<b>24VAC</b>	Us: 24 VAC
<b>24VDC</b>	Us: 24 VDC
<b>48VAC</b>	Us: 48 VAC
<b>110VAC</b>	Us: 110 VAC
<b>230VAC</b>	Us: 230 VAC

## Documents

---

**Operating instructions and Declaration of conformity** (it) 470 kB, 15.04.2016

Code: mrl\_azm190\_it

**Operating instructions and Declaration of conformity** (jp) 576 kB, 19.05.2017

Code: mrl\_azm190\_jp

**Operating instructions and Declaration of conformity** (fr) 474 kB, 27.04.2016

Code: mrl\_azm190\_fr

**Operating instructions and Declaration of conformity** (pl) 509 kB, 19.04.2016

Code: mrl\_azm190\_pl

**Operating instructions and Declaration of conformity** (en) 470 kB, 14.03.2016

Code: mrl\_azm190\_en

**Operating instructions and Declaration of conformity** (cn) 553 kB, 01.06.2017

Code: mrl\_azm190\_cn

**Operating instructions and Declaration of conformity** (nl) 371 kB, 29.04.2014

Code: mrl\_azm190\_nl

**Operating instructions and Declaration of conformity (pt)** 474 kB, 17.02.2017

Code: mrl\_azm190\_pt

**Operating instructions and Declaration of conformity (es)** 472 kB, 06.04.2016

Code: mrl\_azm190\_es

**Operating instructions and Declaration of conformity (de)** 472 kB, 14.03.2016

Code: mrl\_azm190\_de

**BG-test certificate (en)** 166 kB, 27.02.2014

Code: z\_m19p02

**BG-test certificate (de)** 169 kB, 27.02.2014

Code: z\_m19p01

**CCC certification (cn)** 872 kB, 16.08.2016

Code: q\_azmp07

**CCC certification (en)** 896 kB, 16.08.2016

Code: q\_azmp06

**EAC certification (ru)** 809 kB, 05.10.2015

Code: q\_6040p17\_ru

## Images

---

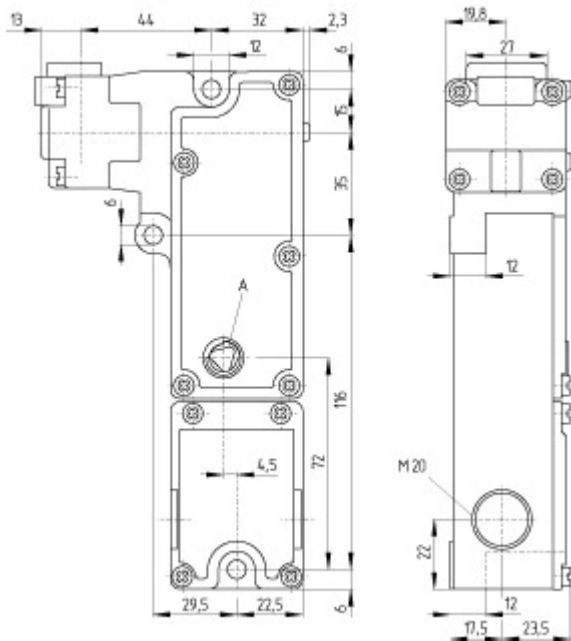

Dimensional drawing (basic component)

---

## System components

---

### Actuator

**101029965 - AZM190-B1**

- Compensation for tolerances by means of rubber buffers



---

**101029967 - AZM190-B3/1X15**



---

**101029968 - AZM190-B3/1X7,5**



---

**101029938 - AZM190-B3/2X15**

- For very small actuating radii in line with or at 90° to the plane of the actuator



---

**101029966 - AZM190-B5**

- Particularly suitable for front mounting e.g. on hinged guards



---

**103009445 - AZM190-B3V/15**

- Especially for aluminium profiles



---

**103009443 - AZM190-B3V/2X15**

- For very small actuating radii in line with or at 90° to the plane of the actuator
- Especially for aluminium profiles



---

**103009444 - AZM190-B3V/7,5**

- Especially for aluminium profiles



---

## Accessories



### 101029969 - MP190 MOUNTING PLATE

- For simple mounting of an AZM190 on profile systems



### 101028565 - TRIANGULAR KEY TZ-75

- For manual release
- angled triangular key



### 103009486 - MP190-V MOUNTING PLATE

- Mounting of the solenoid interlock and mounting plate on the inside for right-hinged doors



### 103009487 - MP190-VD MOUNTING PLATE

- Mounting of the solenoid interlock and mounting plate on the inside for left-hinged doors

---

K.A. Schmersal GmbH & Co. KG, Möddinghofe 30, D-42279 Wuppertal

The data and values have been checked thoroughly. Technical modifications and errors excepted.

Generiert am 15.09.2017 - 11:27:32h Kasbase 3.2.7.F.64I