

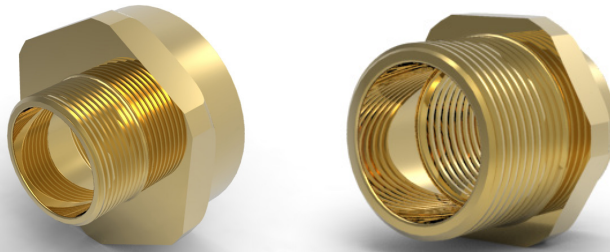

476

Adaptors and Reducers



Metallic Adaptor and Reducer Range; designed to increase or reduce entry thread sizes when mounted to an enclosure. Suitable for use in Flameproof and Increased Safety protection concepts along with mining applications

Technical Data

Ingress Protection	IP66*
Operating Temperature	-60°C to +200°C**
Construction Materials	Manufactured in Brass (Standard), Nickel Plated Brass or 316L Stainless Steel
Threadform	M16 to M130*** 3/8" NPT to 6" NPT
<i>*In order to maintain IP rating at the joints a suitable sealing method must be used.</i> <i>**With No IP Seal fitted</i> <i>***For M16-M75: Metric Thread Length 15mm as standard; Metric Thread Pitch 1.5mm as standard</i> <i>For M80-M130: Metric Thread Length 20mm as standard; Metric Thread Pitch 2mm as standard</i>	

Approvals

Applications	Suitable for Use in Zone 1, Zone 21, Zone 2, Zone 22 and mining applications
Protection Class	Ex II 2GD Ex db eb IIC Gb; Ex tb IIIC Db Ex I M2 Ex db eb I Mb
Construction & Test Standards	IEC/EN 60079-0, IEC/EN 60079-1, IEC/EN 60079-7 and IEC/EN 60079-31
ATEX Certificate No	Baseefa 11ATEX0067X
UKEx Certificate No	BAS21UKEX0057X
IECEx Certificate Number	IECEx BAS11.0037X
Marine Approvals	ABS: 17-LD1653734-PDA BV: 43523/B0
Additional Certifications	CCC: 2020312313000308 EN EAC: No EA3C RU C-GB.HA91.B.00265/21 EQM: 20-11-27224/Q20-11-000979/NB0007 Inmetro: IEx 15.0193X SONCAP: LCOGB049552-0500
NEC/CEC	
NEC Protection Class	CI D1 ABCD CII EFG CIII: CI Zn1 AEx d e IIC Gb; Zn 21 AEx tb IIIC Db
CEC Protection Class	Ex db eb IIC Gb; Zn 21 Ex tb IIIC Db
c CSA us Certificate	1731876
Construction & Test Standards	CSA C22.2 No. 25-1966, 30-M1986, 45-M1981, 94-M91, 18.3.-12 CSA/UL 60079-0, CSA/UL 60079-1, CSA/UL 60079-7, CSA/UL 60079-31, UL514B

Ordering Information

If brass is required please omit material selection
Format for ordering is as follows: Thread configuration should state (A) Adaptor or (R) Reducer

Product	Thread Configuration	Male Thread Size	Female Thread Size	Material
476	A	M25	1.0	NP

Part code example - 476AM251.ONP

Please note all NPT entries should be state as a decimal

476 Allowable Thread Combinations																		
KEY: A = Adaptor R = Reducer		Female Thread																
		M16	M20	M25	M32	M40	M50	M63	M75	M80	M90	M100	M110	M115	M120	M130		
		3⁄8"	1⁄2"	3⁄4"	1"	1 1⁄4"	1 1⁄2"	2"	2 1⁄2"		3"	3 1⁄2"		4"			5"	6"
Male Thread	M16	A	A	A														
	M20	R	A	A	A													
	M25	R	R	A	A	A												
	M32	R	R	R	A	A	A											
	M40	R	R	R	R	A	A	A										
	M50	R	R	R	R	R	A	A	A									
	M63	R	R	R	R	R	R	A	A	A								
	M75	R	R	R	R	R	R	R	A	A	A							
	M80	R	R	R	R	R	R	R	R	A	A	A						
	M90	R	R	R	R	R	R	R	R	R	A	A	A					
	M100	R	R	R	R	R	R	R	R	R	R	A	A	A				
	M110	R	R	R	R	R	R	R	R	R	R	R	A	A	A			
	M115	R	R	R	R	R	R	R	R	R	R	R	R	A	A	A		
	M120	R	R	R	R	R	R	R	R	R	R	R	R	R	A	A		
	M130	R	R	R	R	R	R	R	R	R	R	R	R	R	R	A		
	5"	R	R	R	R	R	R	R	R	R	R	R	R	R	R	R	A	
	6"	R	R	R	R	R	R	R	R	R	R	R	R	R	R	R	R	A
Metric		NPT																